



CASE STUDY

50 Kensington Gardens Square, Bayswater

8Build's stunning London apartments required the installation of wetrooms & waterproofing solutions onto timber floors.

THE CHALLENGE

8Build deliver high quality construction projects to be proud of. 50 Kensington Gardens Square is a luxury apartment complex that has been converted from an existing commercial building into high end residential apartments. Situated a ten minute walk from Paddington Station, 50 Kensington Gardens Square has been heavily refurbished into 30 luxury apartments. Wetrooms UK were

approached by 8Build to supply and install drainage and waterproofing solutions into 26 wetrooms within the apartment block, as well as providing tanking solutions to 32 bathrooms and utility cupboards within the complex.

All wetroom drainage and waterproofing products were required to be suitable for use on timber floors, with the drainage connecting to existing waste pipes.



THE SOLUTION

Wetrooms UK recommended the installation of the BBA approved Modular Wet-Floor Waterless Trap System, which was best suited to the minimal floor construction depth of the 'Danskin' timber floor system specified. Stone Infill Grills of varying lengths were issued to the tiling contractor ensuring a modern, contemporary finish was achieved.

All wetrooms and bathrooms were waterproofed using RIW Tilesafe membrane to the corner junctions on the walls within the shower or bath area, and across the entire floor; finishing 75mm up the wall/floor junction. RIW FWM was also supplied and installed full height to the shower & bath walls, linking to the RIW Tilesafe membrane, to complete the drainage and waterproofing system.

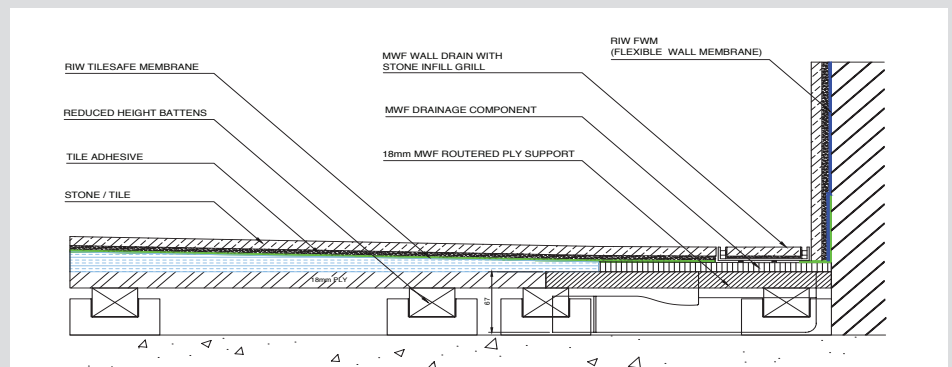

CLIENT TESTIMONIAL:

"As part of their comprehensive installation service, Wetrooms UK's project managers worked closely with Brimelow McSweeney Architects, to design & specify the most appropriate wetroom solution for 8Build. Their project management service included pre-start visits, surveys and the use of skilled operatives on-site. Their 10 year installation guarantee provides 8Build with the peace of mind that the wetrooms at 50 Kensington Gardens Square are fully guaranteed."

Simon White-Miller, Construction Manager

PRODUCTS SPECIFIED

Modular Wet Floor Systems

600mm – 1500mm
Stone In-Fill Grills

RIW Tilesafe Kits

RIW Flexible Wall Membrane (FWM)