

CASE STUDY

Aerotel, Terminal 3, Heathrow Airport

Aerotel is a transit hotel located landside at Heathrow Airport, Terminal 3, providing comfort and convenient booking hours that suit travellers' needs.



THE CHALLENGE

The CCL Group of Companies, comprising Waterproofing Specialists **Cast Contracting Ltd**, & Specialist Wetroom Installers **Wetrooms UK**, were contacted by **ATS Interiors Ltd** to provide waterproofing solutions to the concrete slab of bathrooms and service risers within the back of house linen stores, staff changing areas and washrooms.

In addition, a wetroom drainage & waterproofing solution for the 82 guest suites was required,

suitable for installing onto a shallow floor construction and able to cope with flow rates of up to 29 L/min.

CCL & Wetrooms UK collaborated on the project to provide a comprehensive structural and wetroom waterproofing solution for the hotel.



THE SOLUTION

To complete the structural waterproofing requirements, **Cast Contracting Ltd** installed two coats of **RIW Toughseal** to the concrete slabs of bathrooms & service risers, returning onto upstands by 150mm. **RIW Flexiseal Pro** was then applied to all wall/floor junctions to reinforce the joints to deal with minor movement in the structure.

Due to the shallow 60mm floor construction, which comprised of a cradle and batten floor system on top of a structural slab, **Wetrooms UK** recommended the installation of the 55mm **Modular Waterless Trap**, 1100mm **Solid Stainless Steel Wall Grill** and a **Modular Wet-Floor Tapered Board** (to create the gradient) into each guest ensuite.

The wetrooms were waterproofed using **RIW Tilesafe** membrane across the entire floor, finishing 75mm up the wall/floor junction

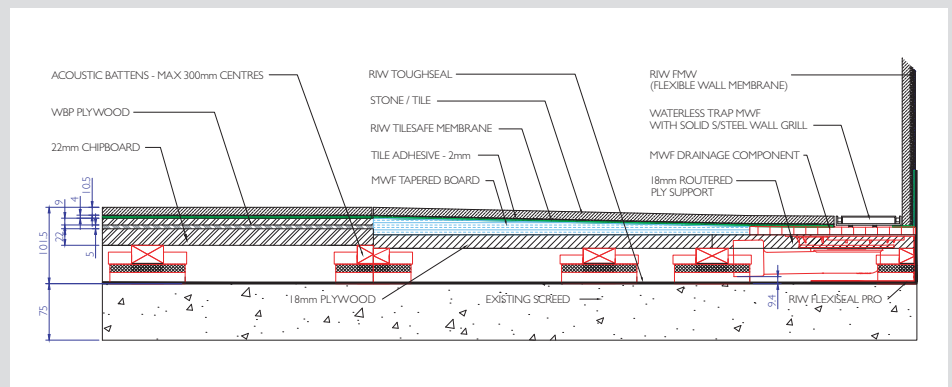

and protecting critical joints on the shower area walls. **RIW FWM** was supplied and installed to 2.2m high on the shower walls, linking to the **RIW Tilesafe** membrane, to complete the drainage and waterproofing system.

The **Modular Waterless Trap** at a cutting-edge depth of only 55mm, is the shallowest approved waterless trap on the market. It was ideal for use in this shallow floor construction project which could not accommodate a standard depth waterseal drain.

PRODUCTS SPECIFIED

- Modular Waterless Trap
- Modular Wet-Floor System (Waterless Trap Base Component & 1500mm Tapered Board)
- 1100mm Solid S/Steel Wall Drain
- RIW Tilesafe Kit
- RIW Flexible Wall Membrane
- RIW Toughseal
- RIW Flexiseal Pro